

M/V KIRT CHOUEST | Anchor Handling Tug Supply Vessel



M/V Kirt Chouest



SPECIFICATIONS

REGISTRATION

| | |
|-------------|-----------------------------------|
| Vessel Type | Anchor Handling Tug Supply Vessel |
| Year Built | 2008 |

ACCOMMODATIONS

| | |
|----------------|------------------------|
| Accommodations | 42 (2 person sick bay) |
|----------------|------------------------|

DIMENSIONS

| | |
|------------------|--|
| Dimensions | 288 ft. X 66 ft. X 29.6 ft. (87.78 m X 20.12 m X 8.99 m) |
| Draft (Loadline) | 23 ft. (7.01 m) |
| Cargo Deck Area | 7,474 sq. ft. (692.36 cu. m) |

SPECIAL FEATURES

| | |
|-------------|--|
| Positioning | DP 2 |
| Main Crane | One (1) x 150 MT Knuckle Boom Jib Crane 3,000 m wire |
| Deck Cranes | Two (2) x 5-Ton (4.53 MT) capacity |
| ROV | One (1) Schilling Robotics UHD Gen. 3 250HP |
| ROV | One (1) Schilling Robotics UHD Gen. 2, 200HP, 400M systems |

C-INNOVATION • 985.612.1700 • WWW.C-INNOVATION.COM



M/V KIRT CHOUEST | Anchor Handling Tug Supply Vessel



SCHEMATICS

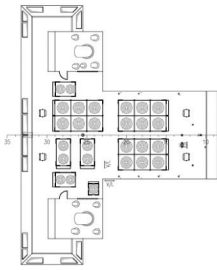

DECK 05

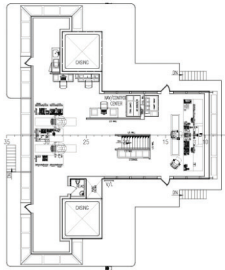

DECK 04

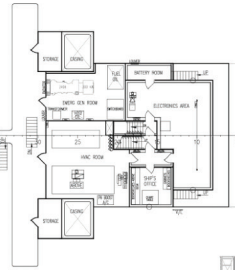

DECK 03

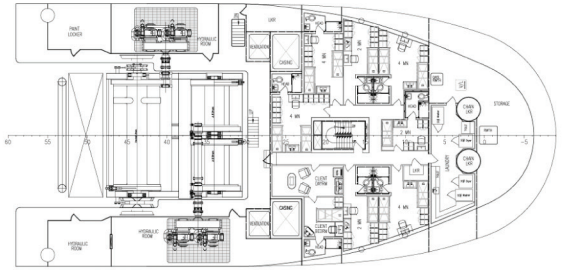

DECK 01

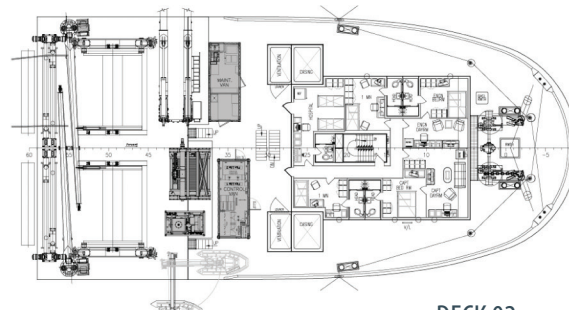
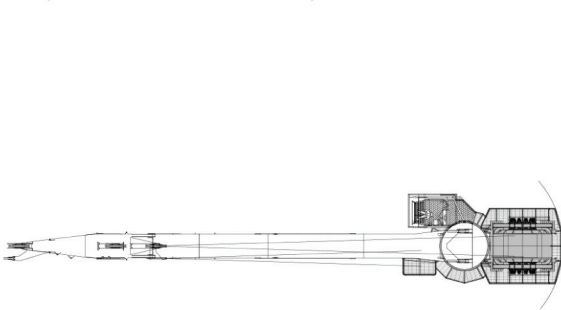

DECK 02

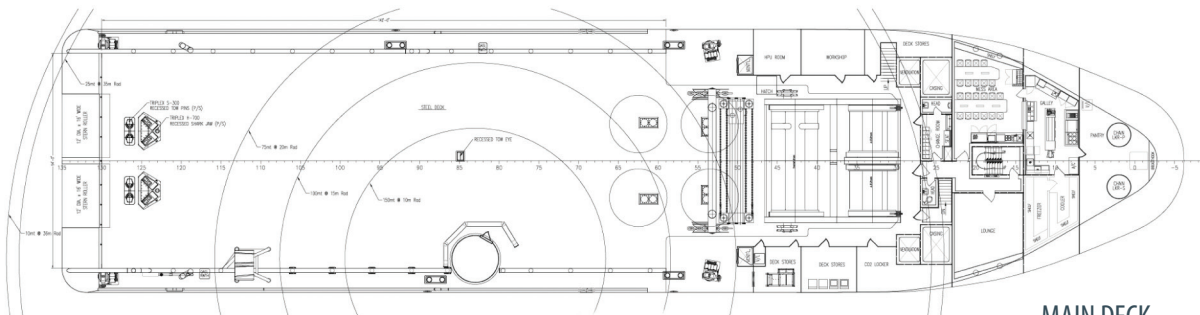

MAIN DECK

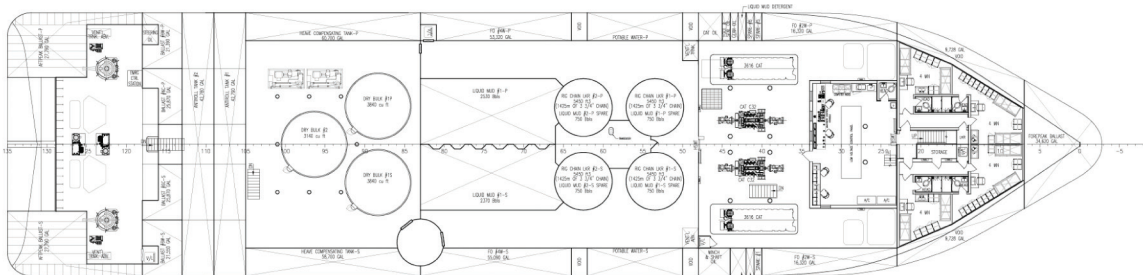

LOWER DECK